



# FIRESTOP CENTRE

Authorised New Zealand Distributor  
Ph (09) 483 4000 www.firestopcentre.co.nz

## Allproof Low Profile Fire Collar Plastic Pipe through a 78mm Speedpanel Wall See pg 2 for details

### INSTALLATION INSTRUCTIONS:

1. Ensure substrate around the service is flat and free from obstructions.
2. Seal the annular space between the wall and the pipe with Allproof MAS310 fire sealant to a depth of 13mm and for Speedpanel also seal any profile gaps.
3. Open pipe collar and position around the service.
4. Slide tab through slot in pipe collar and fold back 180° to secure.
5. Secure collar using 10G x 38mm needle point screws with 15mm diam washers.

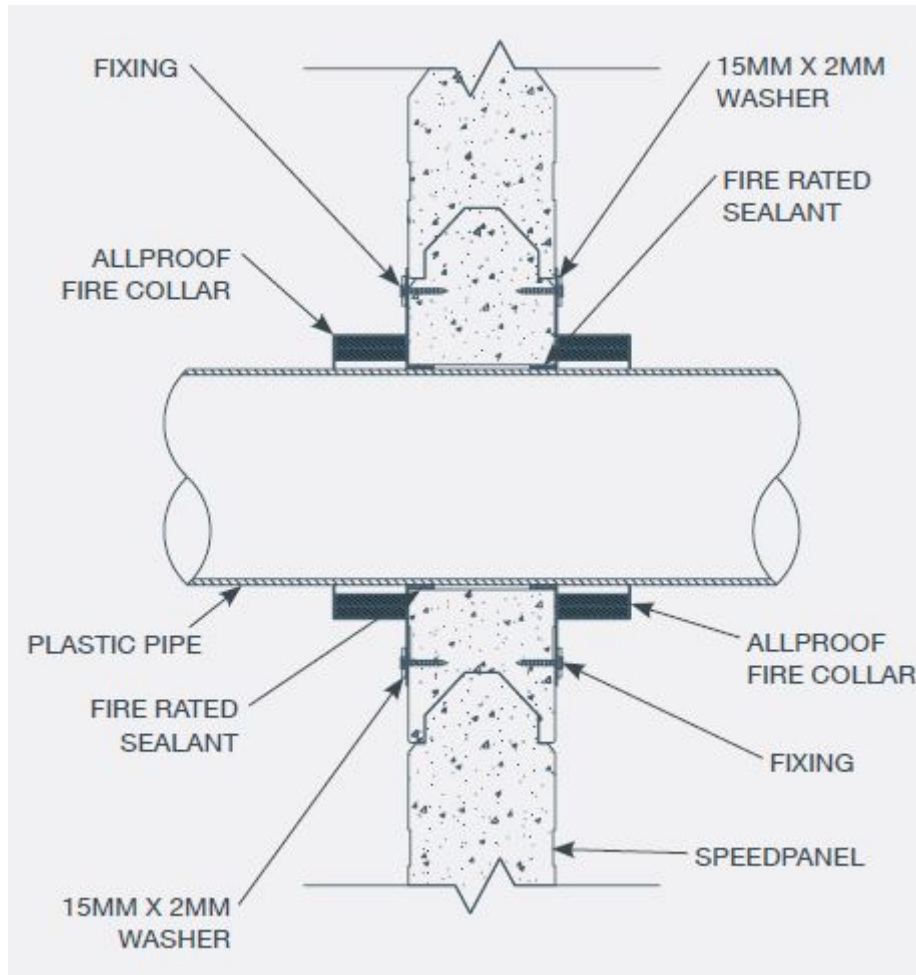

As a part of our policy of on-going product development and testing, we reserve the right to modify, alter or change product specifications without giving notice. All information contained in this document is given in good faith and is provided for guidance only. Any drawings provided are for illustrative purposes only. As Firestop Centre has no control over the methods or competence of installation and of prevailing site conditions, no warranties, expressed or implied, is intended to be given as to the actual performance of the product mentioned or referred to herein and no liability whatsoever will be accepted for any loss, damage or injury arising from the use of the information given.

# ALLPROOF

INDUSTRIES

Allproof Industries Ltd  
17 Bay Park Place  
Beach Haven, AK 0626



BRANZ Appraisal 1008  
Technical Manual - Plumbing Pg 24  
AS1530.4-2014 AS4072.1-2005

System ID# FC750

Products	Allproof Low-Profile Fire Collar
Application	Fire stopping of plastic pipe in concrete or speedpanel wall
Construction	Minimum wall thickness 78mm

### Fire Classification:

See page 2 for details of pipe types, sizes and FRR ratings for:

PVC up to 150mm  
HDPE up to 110mm

Sheet size: <b>A4</b>	Drawn date & no: 28/5/25
Scale: <b>NTS</b>	Drawn by: G.P

# SPEEDPANEL TEST RESULTS:

NOMINAL PIPE SIZE (MM)	PANEL DEPTH (MM)	NOMINAL PIPE WALL THICKNESS (MM)	PRODUCT CODE	PENETRATION HOLE SIZE (MM)	WALL FRL	REPORT NUMBER
PVC PLASTIC PIPE						
50	78	2.3	ALLFC50	63	-/120/120	190283.1
65	78	2.3	ALLFC65	63	-/120/120	180434.5
80	78	3	ALLFC80	70	-/120/120	180434.5
100	78	3.0	ALLFC100	114	-/120/120	190283.1
150	78	4.2	ALLFC150	165	-/120/90	190283.1
HDPE PLASTIC PIPE						
50	78	3.0	ALLFC50	60	-/120/90	190283.1
110	78	4.3	ALLFC100	114	-/120/90	190283.1

Fixing: Collars tested using 10G x 38mm needle point screws with Ø15mm x 2mm thick washers.  
Note: Fire rated sealant installed between Speedpanel and collar where profile changes (see 'Profile Detail').

## SPEEDPANEL INSTALLATION DETAILS:

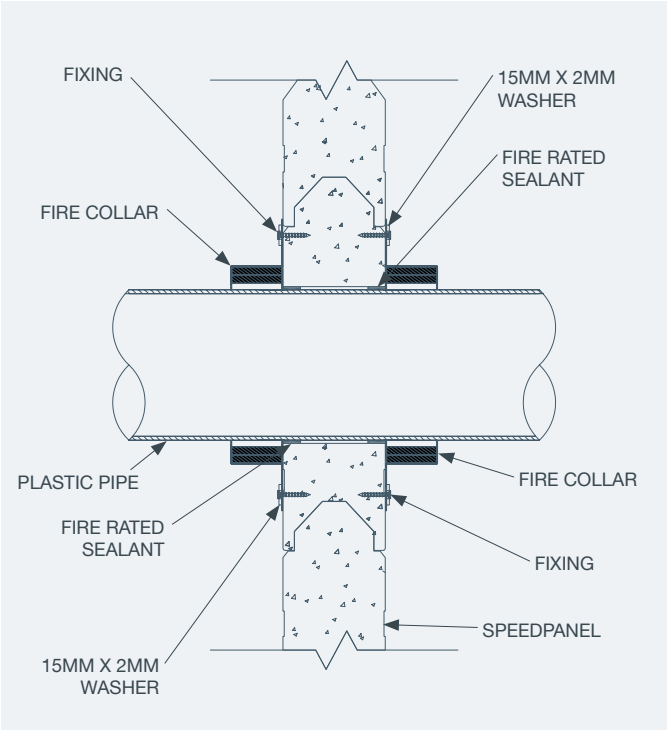

## SPEEDPANEL PROFILE DETAIL:

